

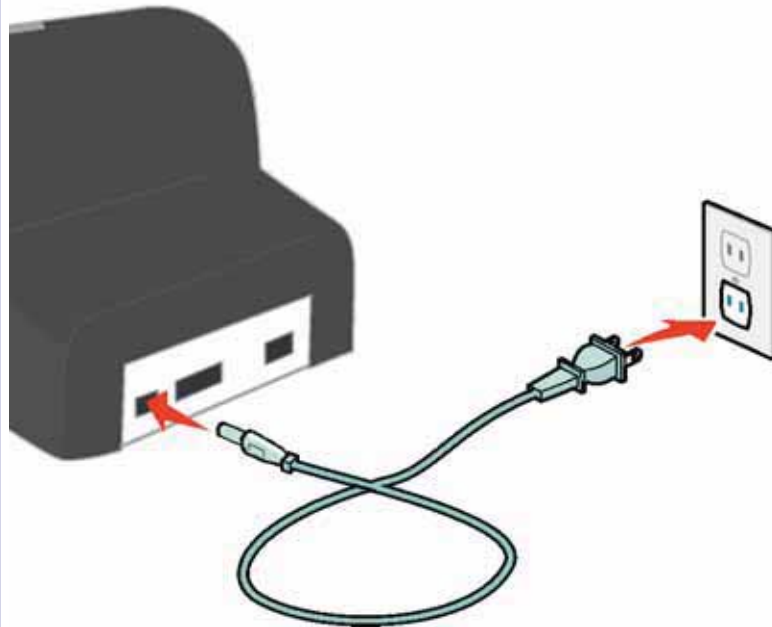

Xi440 Setup

1 Plug In

Remove the AC adapter from the box and plug one end into the power plug at the back of the printer and the other end into an available wall socket.



3 Install Ink

While powered on raise the center lid of the printer and press the leftmost ink exchange button  to slide the ink cartridge holders into position,

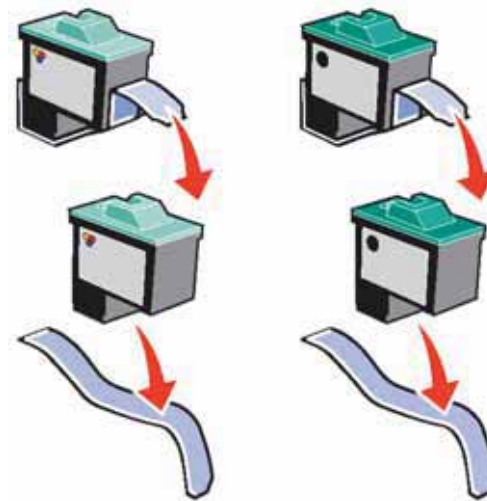
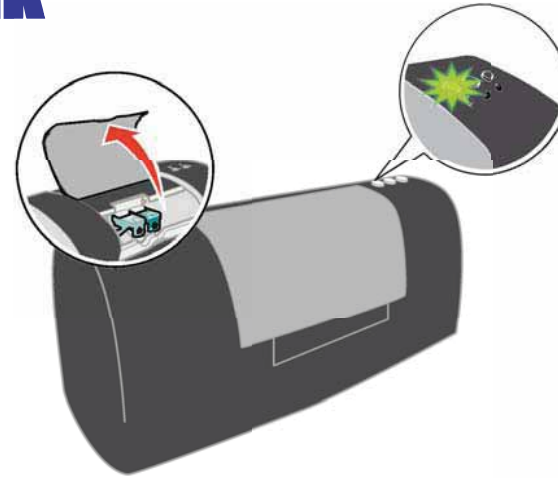

Remove the ink cartridges from their packages and remove the tape covering the print heads taking care not to touch the heads or the gold contacts on the back.

2 Power On

Press and hold the  power button on the far right hand side of the printer until the light comes on.

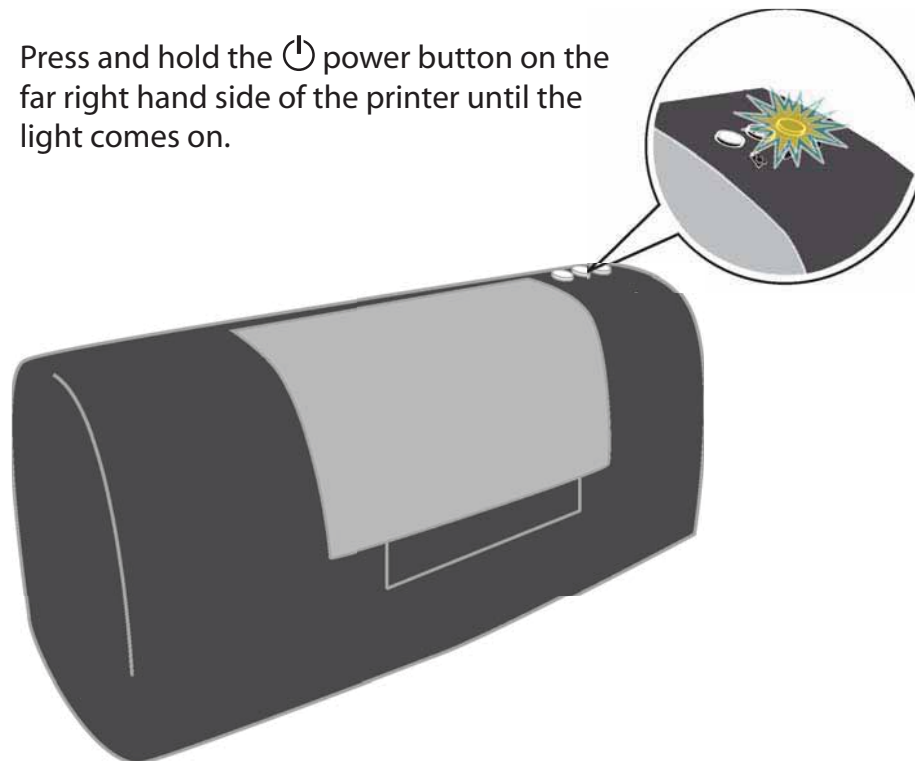

1 Press the tabs on the front of the cartridge holders inward.

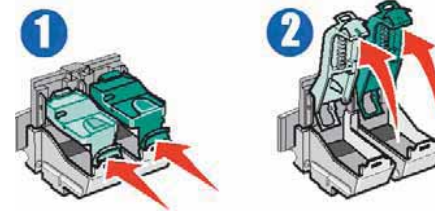

2 While pressing the tabs lift the covers upward to open.

3 Place the ink cartridges into their holders taking note to use the correct color coded holder.

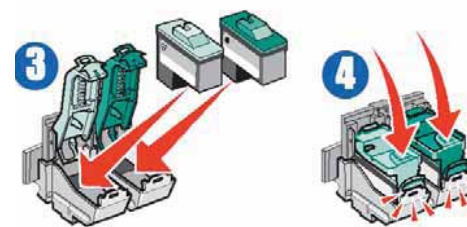

4 Close the covers until they latch onto the lower holders as before.

Please note you should never have to force the ink cartridges into their holders, if excessive force is necessary remove and reinsert the cartridges or check for any obstructions within the holders.

4 Connect Printer

With your computer turned on plug the flat end of the USB cable (1) into an available USB port on the back of your computer, plug the square end of the cable (2) into the USB port on your printer.

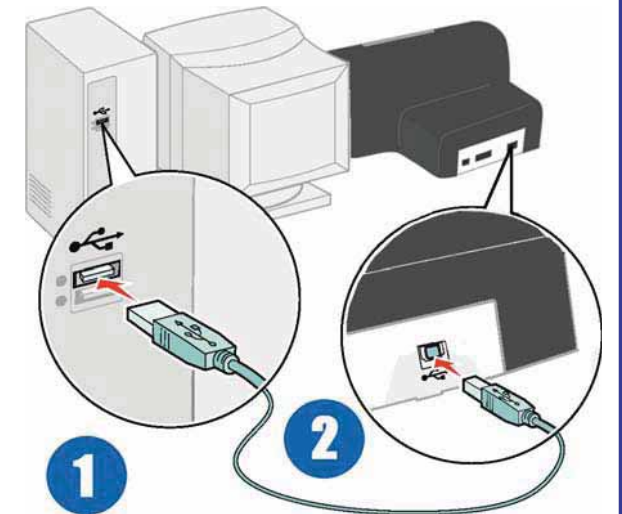

5 Install Software

Download the Mac Xi440 Printer Driver from XLNT Idea at http://www.xlntidea.com/downloads/Software/Drivers/Xi440_Mac.zip after the file has been downloaded to your desktop and unzipped you will see the Xi440_Mac.dmg file.



Double click this file to open it and continue to step 6 on the back side of this quick start guide.

6

Software Installation

With the **XLNTIdea CD Printer** powered on and connected to your Mac. Open the Xi440_Mac.dmg and the following disc image will appear onto your desktop. Double click this disc to continue.



The Xi440_Setup disc contains the software installer, double click **Xi440 installer.pkg** to begin installation.



The following screen will appear click **Continue**.



Select the location you wish to install the software, then click **Continue**.



After the software has finished installing click **Continue** again to close the installation.

Open the **System Preferences** window by clicking the following icon in the Dock.



Click the **Print & Fax** icon in the System Preferences window to open the following window.



Click the Add (+) button to add the Xi440 to your printers menu.

This will search for the printer driver and open the following screen.

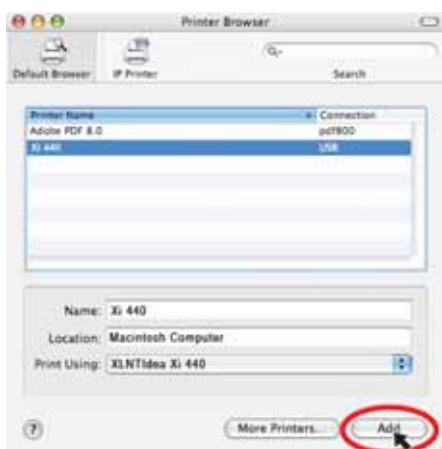

Select Xi440 from the list and click the **Add** button to finish the software installation.

7

Cartridge Alignment

The ink cartridges must be aligned to provide the best quality prints. The alignment setup will automatically run each time new print cartridges are installed. To align the cartridges follow the instructions below.

Open the **Print & Fax** control panel from the **System Preferences** window and the following window will appear. Double click on the Xi440 Printer name in the left hand box.

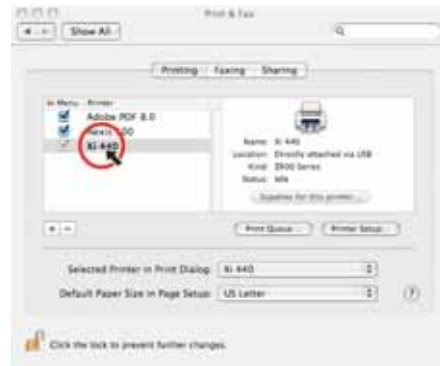

The following window will open. Click the **Utilities** button at the top of the window to continue.



In the following window. Click the **Align Cartridges** button on the left side of the window to continue.



Click the Continue button and your Xi440 will automatically begin the alignment print.



When the disc has finished printing look at the arrows printed onto the disc, use your best judgement and pick the arrow the stands out most from the surrounding lines taking note of the letter (**A,B,C or D**) next to each line.



Bad Arrow



Bad Arrow



Good Arrow



Good Arrow

In the window that pops up enter the value you've determined to be the best in the by using the up and down arrows to change the value.

Note: Since only even numbers are printed during the test only select an odd number if the the even numbered blocks next to each other are the same.

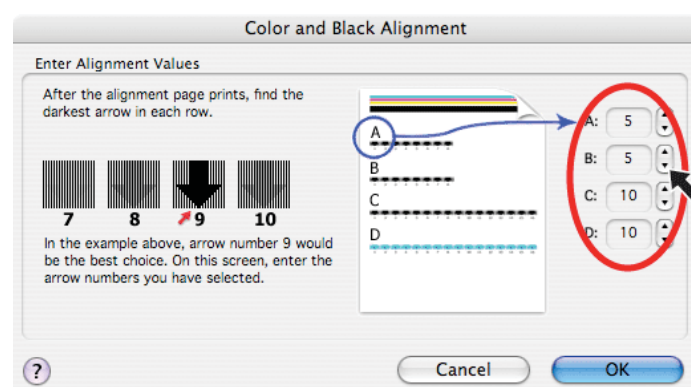

When you are finished click the **OK** button to close the window.

Congratulations you have successfully setup your XLNTIdea Xi440 CD/DVD Printer for optimum printing