

Xi440 Setup

1 Plug In

Remove the AC adapter from the box and plug one end into the power plug at the back of the printer and the other end into an available wall socket.

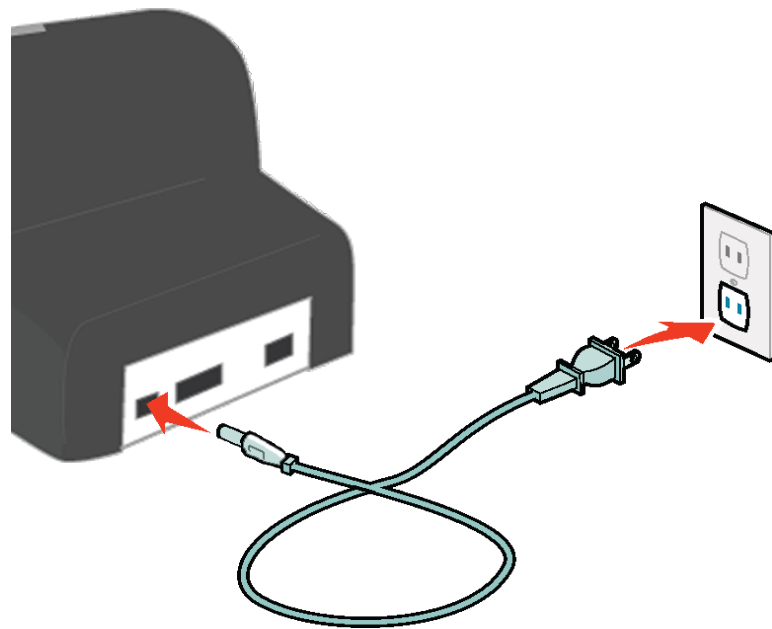

2 Power On

Press and hold the power button on the far right hand side of the printer until the light comes on.

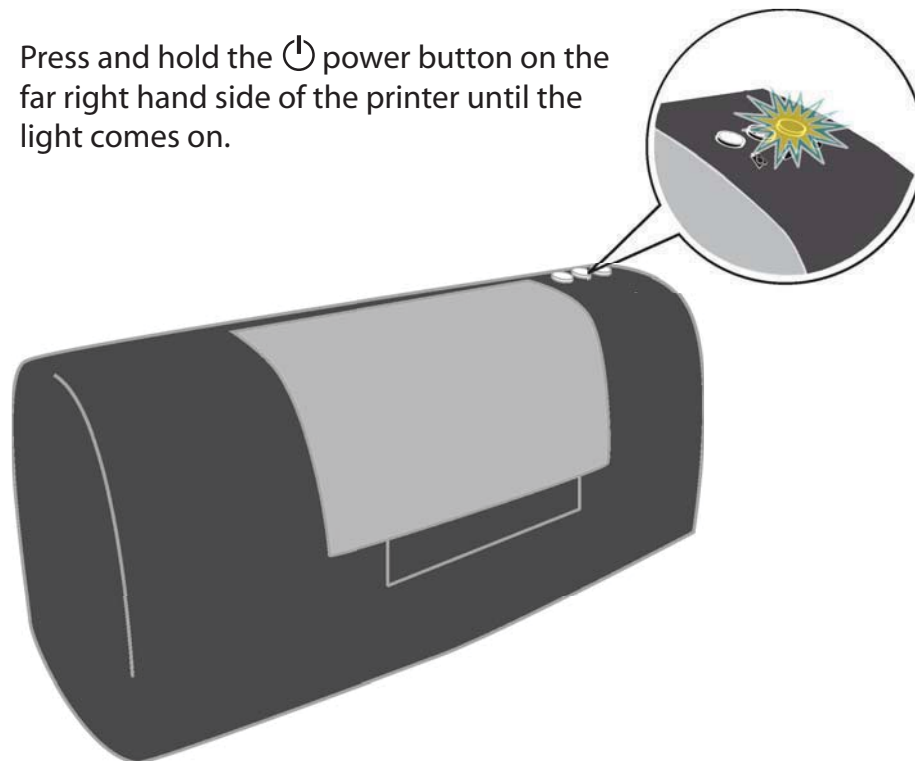

3 Install Ink

While powered on raise the center lid of the printer and press the leftmost ink exchange button to slide the ink cartridge holders into position,

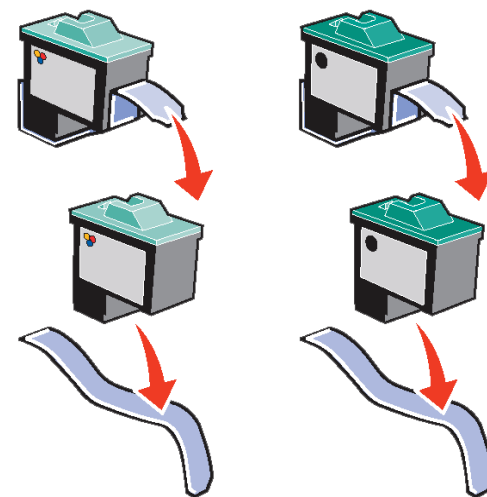
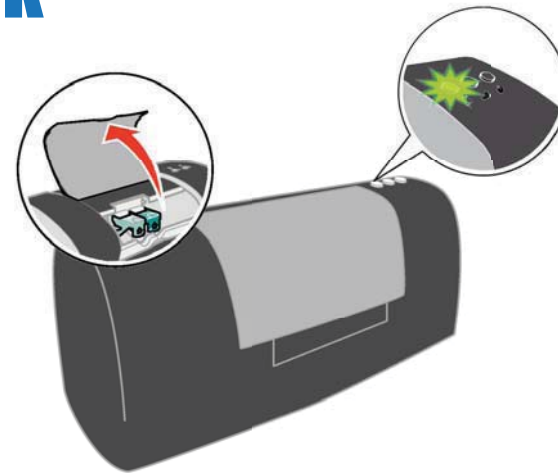

Remove the ink cartridges from their packages and remove the tape covering the print heads taking care not to touch the heads or the gold contacts on the back.

1 Press the tabs on the front of the cartridge holders inward.

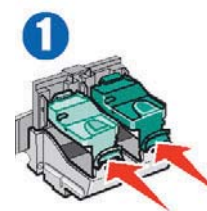

2 While pressing the tabs lift the covers upward to open.

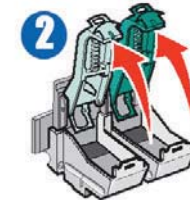

3 Place the ink cartridges into their holders taking note to use the correct color coded holder.

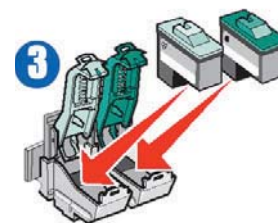

4 Close the covers until they latch onto the lower holders as before.

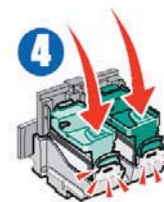

Please note you should never have to force the ink cartridges into their holders, if excessive force is necessary remove and reinsert the cartridges or check for any obstructions within the holders.

4 Connect Printer

With your computer turned on plug the flat end of the USB cable (1) into an available USB port on the back of your computer, plug the square end of the cable (2) into the USB port on your printer.

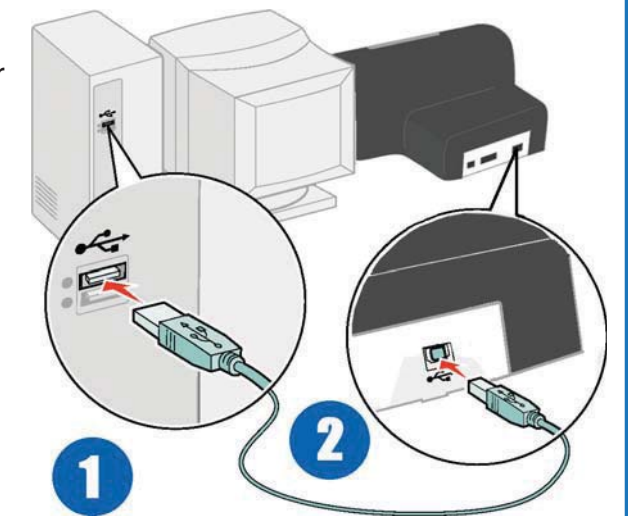

5 Install Software

Place the XLNTIdea software installer CD into your CD-ROM or DVD drive and continue to step 6 on the back side of this quick start guide.

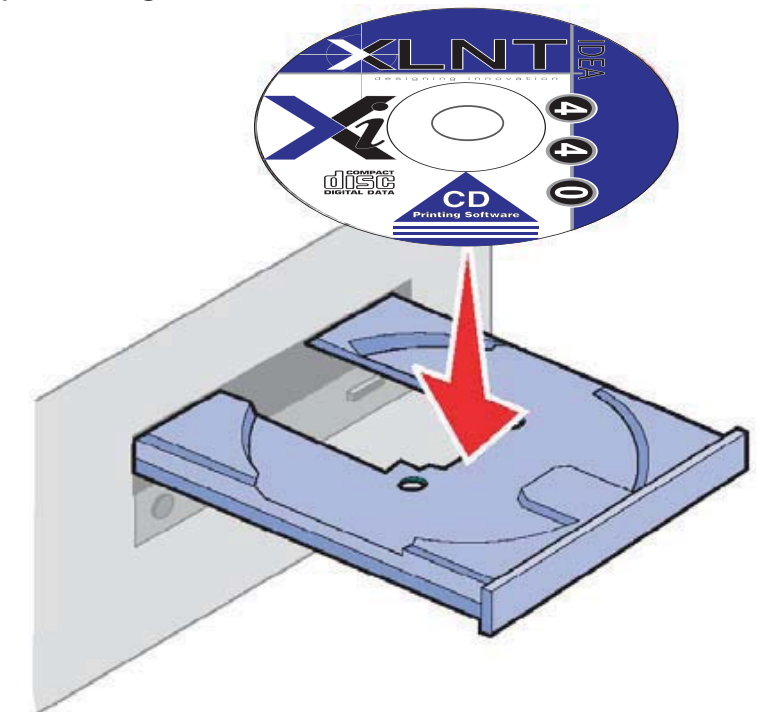

xlnt idea

6 Software Installation

After the **XLNTIdea CD Printer** has been powered up and connected to your computer, windows should automatically detect the X1440 Printer and displayed the following screen as shown below :



Select the option "No, not at this time". Then select "Next". The following screen will appear:

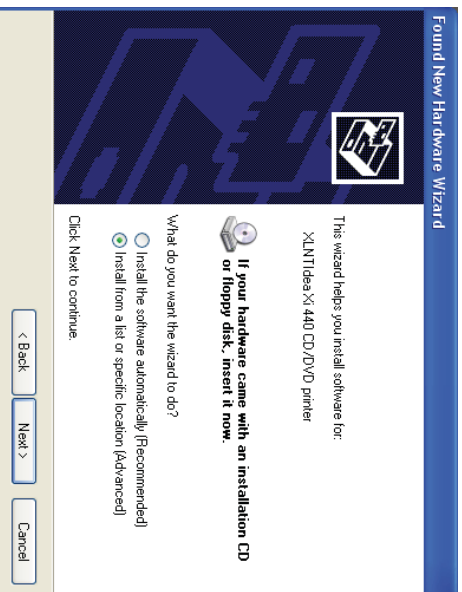

Select the option "Install from a list or specific Location (Advanced)". Then select "Next". The screen shown below will appear. From this menu select "Search removable media (floppy, CD-ROM,...)" Then select "Next".

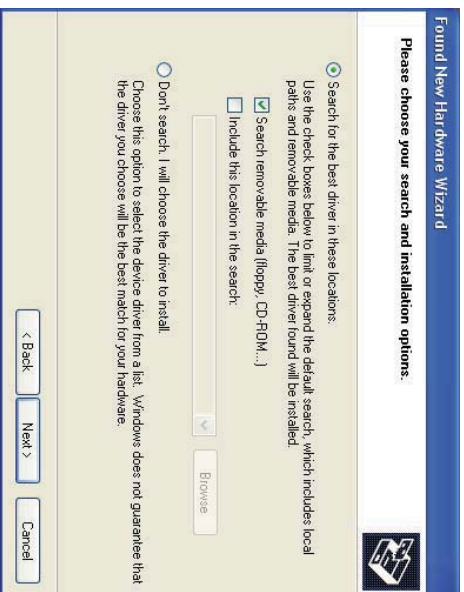

Once your computer locates and begins copying the drivers from the CD-ROM the below message will appear. Select "Continue Anyways".

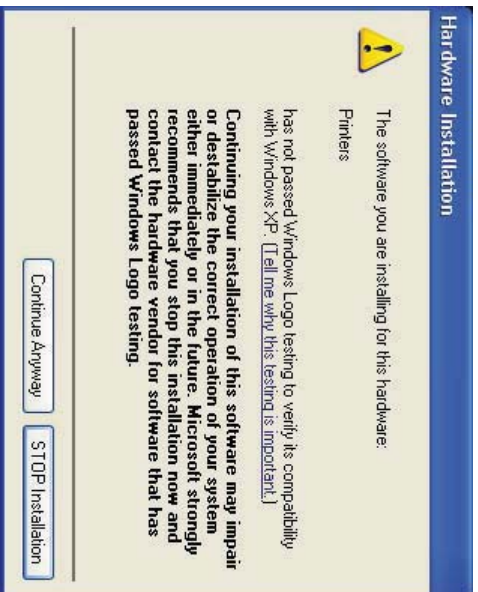

After the X1440 driver installation has completed the following screen will appear. Select "Finish". Once this is complete proceed to step 7. You must align the new inkjet cartridges you installed for best print quality.

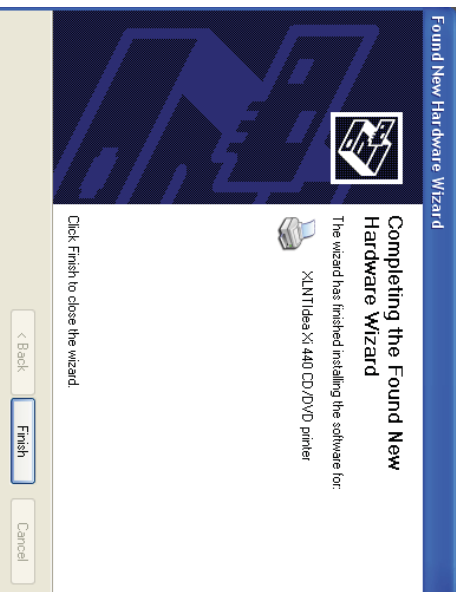

7 Cartridge Alignment

To align the ink cartridges goto "Start Menu -> Settings -> Printers and Faxes". Find the X1440 printer and right click on it. Then select "Properties". The screen below will appear. Then select "Cartridge Maintenance" tab in the **XLNTIdea X1440 CD/DVD printer Properties** window and then **Click** the "Install/Change Cartridge" button.

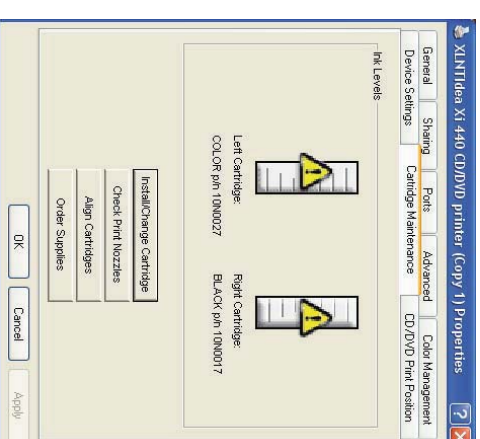

From the pull-down menus select the type of cartridge you have installed. (XLNTIdea X1440 is shipped with **10N0027** and **10N0017** cartridges). Then select "Continue".

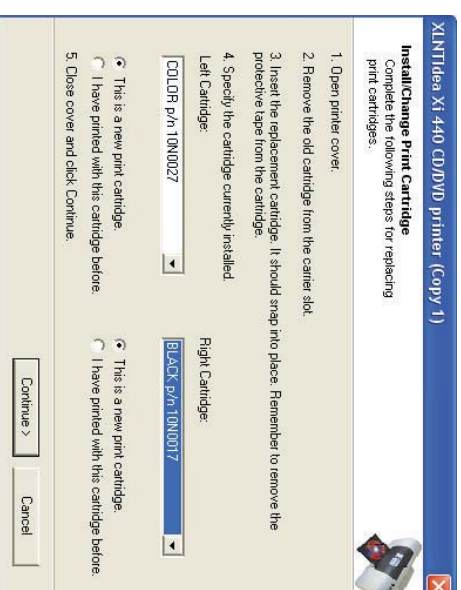

The XLNTIdea X1440 will now eject its CD/DVD print tray and the center control light will turn **RED**, Place a **Blank Inkjet Printable** CD/DVD into the tray with the CD/DVD disc into the printer and begin the "Cartridge Alignment Test".

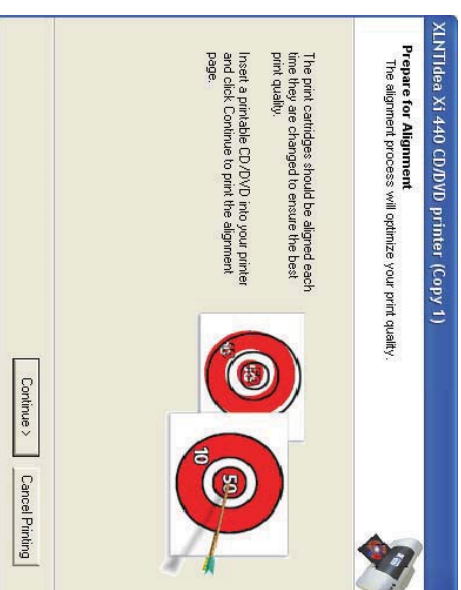

When the disc has finished printing and using your best judgement pick the arrow that stands out most from the surrounding lines. Take note of the letter (**A, B, C or D**) next to each arrow. Enter the value When you are finished **Click** the "OK" button to close this window.

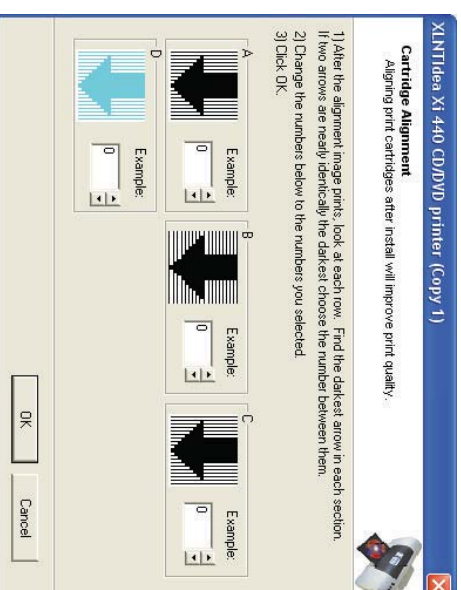
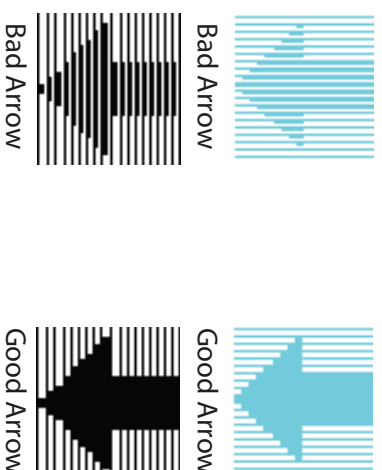

Congratulations you have successfully setup your XLNTIdea X1440 CD/DVD Printer for optimum printing.